

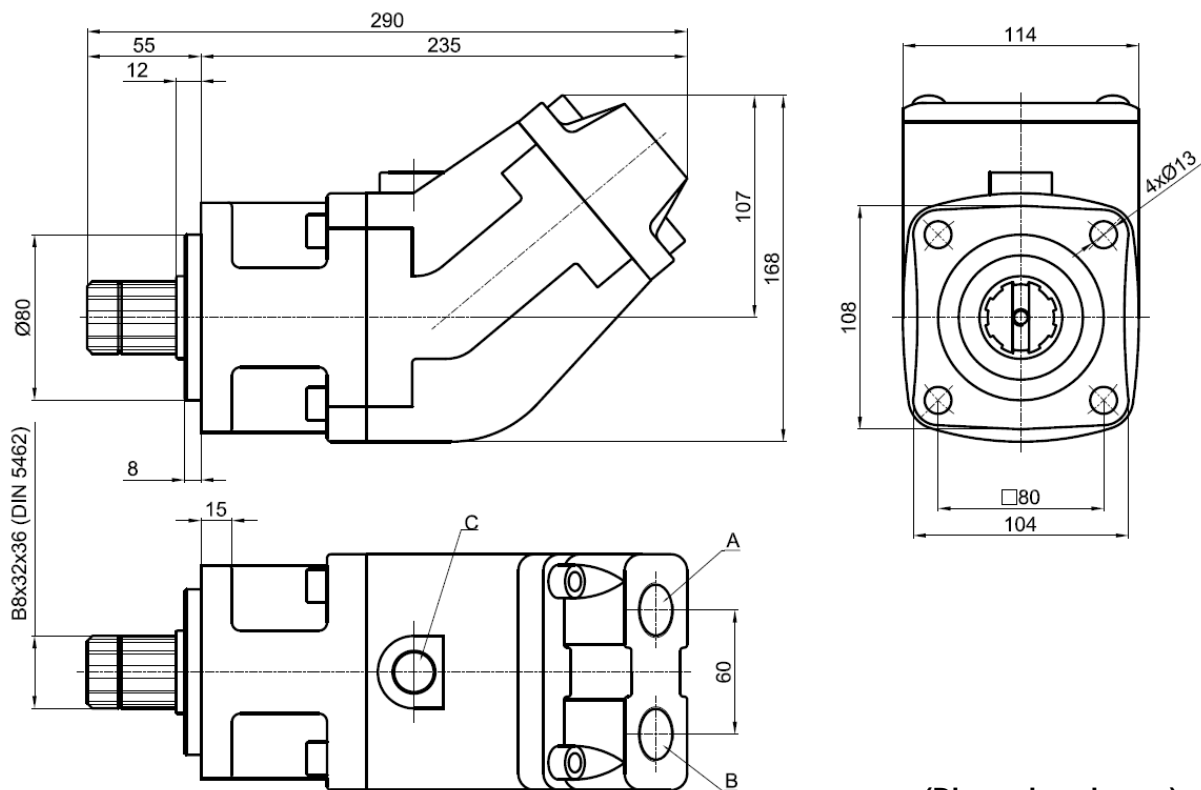

OIL-HYDRAULIC BENT MOTOR AXIAL PISTONS

Ref.
MBI M

Main Dimensions



(Dimensions in mm)

Main Data

Motors MBI		30M	40M	50M
Cylinder capacity (cm ³ /rot.)		32	42	50
Rotation (rpm)	max. intermittent	4000	3500	3000
	max. continuous	3200	2800	2400
Pressure (bar)	max. intermittent	400	400	400
	max. continuous	350	350	350
Max torque – theoretical value (Nm)		190	250	315
Weight (kg)		10	10	10
Pistons quantity		5	5	5
A-Oil port (mm)		3/4" BSP	3/4" BSP	3/4" BSP
B-Oil port (mm)		3/4" BSP	3/4" BSP	3/4" BSP
C-Drain hole		M22x1.5	M22x1.5	M22x1.5

How to order:

Example: Motor 30cm³/rot.; pressures 400/350 bar; rotation 4000/3200; ref. MBI M → MBI30M

Important notes:

-To install one of these motors, please consult and respect the instruction "BI motors recommendations before start-up".

ABER is constantly engaged in improving its products and, therefore, reserves itself the right to modify without any further notice the characteristics shown



ABER - Embraiagens e Comandos Hidráulicos - A. B. LDA

Rua Francisco de Almeida, Nº 30 – Vila Nova da Telha – 4470 MAIA - Portugal

Telephone: +351.22.9438070 Fax: +351.22.9420823 e-mail: aber@aber.pt <http://www.aber.pt>